



Conversion manual for lengthening Orbit series

Provided parts:

- 1x motor lengthening Orbit
- 1x back plate with shaft
- 1x ball bearing 5 x 11 x 5
- 2x Allen screw M3 x 6

needet tools:

- Allen wrench 2.5 mm
- Philips screwdriver PH0

The conversion of the Orbit lengthening is simple and unproblematically. Just follow the next 7 steps. You have to pay attention of a clean work place, when you are fitting your motor. Please take care that no foreign body, like metal swarfs or screws, gets into the motor, they would destroy them. After the successful conversion and before the first use, you have to inspect the motor by hand of a clean and drag free turn.

Step 1

The Orbit lengthening is compatible to all motors of the Orbit series. To get a free shaft length of 20mm, you must shorten the new shaft by the measure x. The best way is a small disc grinder with a fibreglass-reinforced cutting wheel. After shortening you have to deburr the cutting edge with a belt grinder or a piece of abrasive paper.

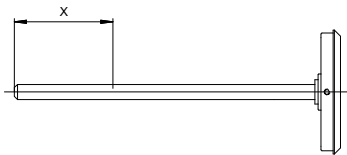

Motor Orbit /	X
10	15
15	10
20	5
25	0

Step 2

Turn off the 4 capstan screws at the rear end of the motor. Please use the Philips screwdriver.

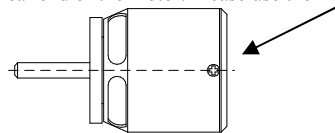

Step 3

Press the shaft with the back plate from front to rear out of the motor. If necessary, hold the motor at the housing and press the motor with the shaft frontward on a table. Don't use a steel hammer to disconnect the shaft from the motor.

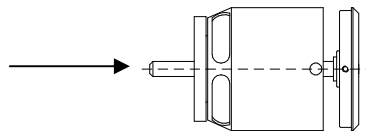

Step 4

Put the new shortened shaft with small pressure through the rear ball bearing and adjust the taphole in line with the borehole. Then provide the 4 capstan screws with threadlocking (medium strength), and turn in with the Philips screwdriver.

Step 5

Press the provided ball bearing into the lengthening.

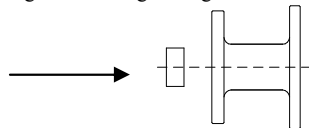

Step 6

Put the Orbit lengthening with the mounted ball bearing over the shaft (the ball bearing outside) and press it down to the motor flange.

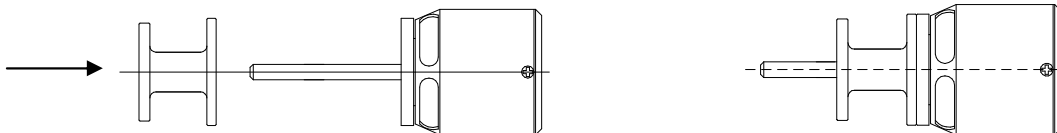

Step 7

Adjust the taphole of the lengthening in line with the borehole in the motor flange. Then screw the lengthened with the two provided M3 screws, take care that the three connection cables lays clean in the milling.

